

NetWaySP2PWPN

3-Port Ethernet over Fiber PoE+ Hardened Outdoor Switch

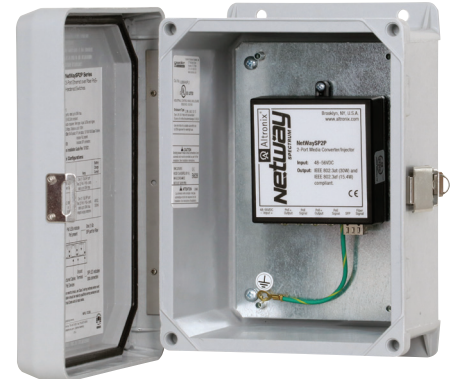

Altronix NetWaySP2PWPN 3-Port PoE+ hardened switch converts a single Fiber (1000Base-X/SX/LX) into two (2) Ethernet ports (10/100/1000 Mbps) and provides PoE/ PoE+ power to connected devices. Mounted in NEMA 4/4X, IP66-11 enclosure, it features auto detection and protection of legacy non-PoE cameras/devices.



NetWaySP2PWPN

Specifications

Input

48-56VDC @ 1.9A (95W)

Fiber Ports

One (1) 1Gb SFP port

Output Power

Two (2) PoE / PoE+ ports, rated up to 30W max.
IEEE 802.3af and IEEE 802.3at compliant

Ethernet

Connectivity: RJ45, auto-crossover
Wire type: 4-pair CAT5e
Distance: up to 100m
Speed: 10/100/1000 Mbps

Indicators (LED)

Yellow and Green LEDs: IP Link status, 10/100/1000 Base-T/active
Green PoE LEDs: PoE present
Green SFP (Fiber) LEDs: SFP connection

Features

Auto detection and protection of legacy non-PoE cameras/devices
NEMA 4/4X, IP66-11 enclosure

Agency Listings

CE European Conformity

Physical and Environmental

Dimensions (W x L x H)

Enclosure: 9.5" x 7.32" x 4.92" (241.3mm x 185.9mm x 125mm)
Shipping: 13" x 10" x 7" (330.2mm x 254mm x 177.8mm)
NEMA 4/4X, IP66-11 Rated enclosure for outdoor use

Weight (approx.)

Product: 3.7 lb. (1.68 kg)
Shipping: 5 lb. (2.27 kg)

Temperature

Operating: -40°C to 70°C (-40°F to 158°F)
Storage: -40°C to 75°C (-40°F to 167°F)

Relative Humidity

85% +/- 5%

Operating Altitude

-304.8 to 2,000m

Typical Application

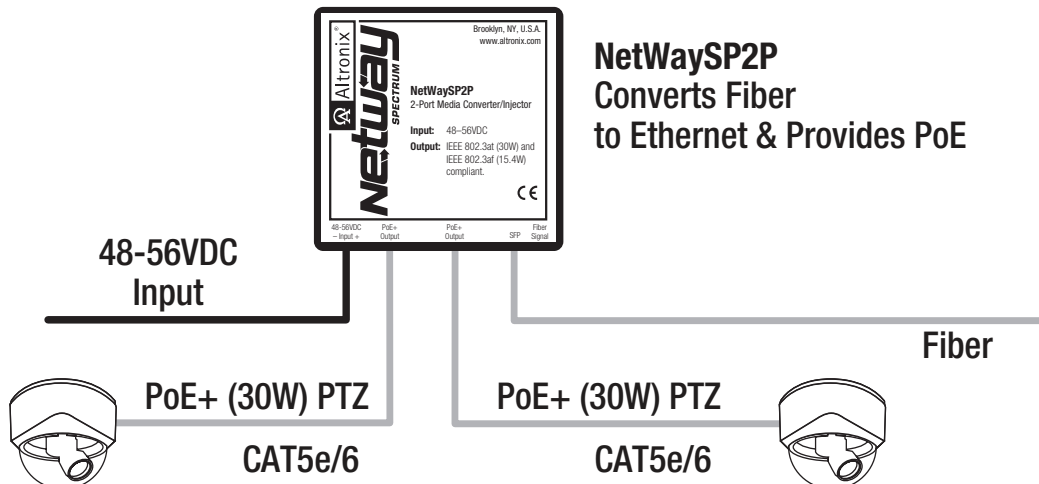

NetWaySP2P
Converts Fiber
to Ethernet & Provides PoE

Lifetime Warranty

Power Sourcing Equipment and Accessories (order separately)



- 4-port Ethernet over Fiber Media Converters for Applications Utilizing Composite or Conventional Cabling**
- NetWaySP4** Unit passes a maximum power up to 120W per port (240W total power) from a Power Supply or Midspan Injector. Four (4) 1Gb SFP ports.
- NetWaySP4P** Unit provides a maximum power up to 120W per port (240W total power) from a built-in Power Supply/ Charger. Four (4) 1Gb SFP ports.
- NetWaySP4P2** Unit provides 56VDC power-limited 60W max. per port (240W total power) from a built-in Power Supply/Charger. Four (4) 1Gb SFP ports.



- SFP Modules - Hot Pluggable Transceivers**
- P1MM** Multi-Mode SFP Module for distances up to 550m
- P1SM10** Single-Mode SFP Module for distances up to 10km
- P1AB2K** Single Strand SFP Module for distances up to 2km
- P1GCE** Copper SFP Module for distances up to 100m

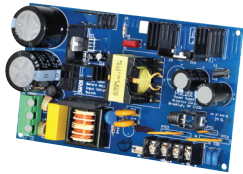

- PoE Power Supplies**
- POE201 - 120W Power Supply/Charger**
Provides 120W for NetWay Spectrum switches.
It also features a built-in charger for sealed lead acid or gel type batteries.
- POE240 - 240W Power Supply/Charger**
Provides 240W for NetWay Spectrum switches.
It also features a built-in charger for Lithium Iron Phosphate or sealed lead acid batteries.

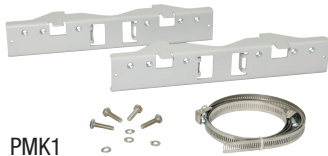

- PMK1 - Pole Mount Kit**
- PMK1 pole mount kit is designed to simplify installation of outdoor units. It accommodates 2" - 8" (diameter) poles.

PMK1

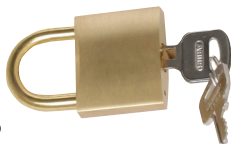

- LOCK1WP - Pad Lock for Altronix Outdoor Enclosures**
- Altronix Lock1WP is a pad lock to secure the latches on Altronix outdoor enclosures. Includes a single pad lock and two (2) keys.

Lock1WP



- WG1 - NEMA Rated Wire Gland Inlet**
- Altronix WG1 facilitates wiring for all Altronix outdoor enclosures.

WG1

Lifetime Warranty

Dimensions and Drawing

Dimensions (H x W x D approximate)

9.5" x 7.32" x 4.92" (241.3mm x 185.9mm x 125mm)

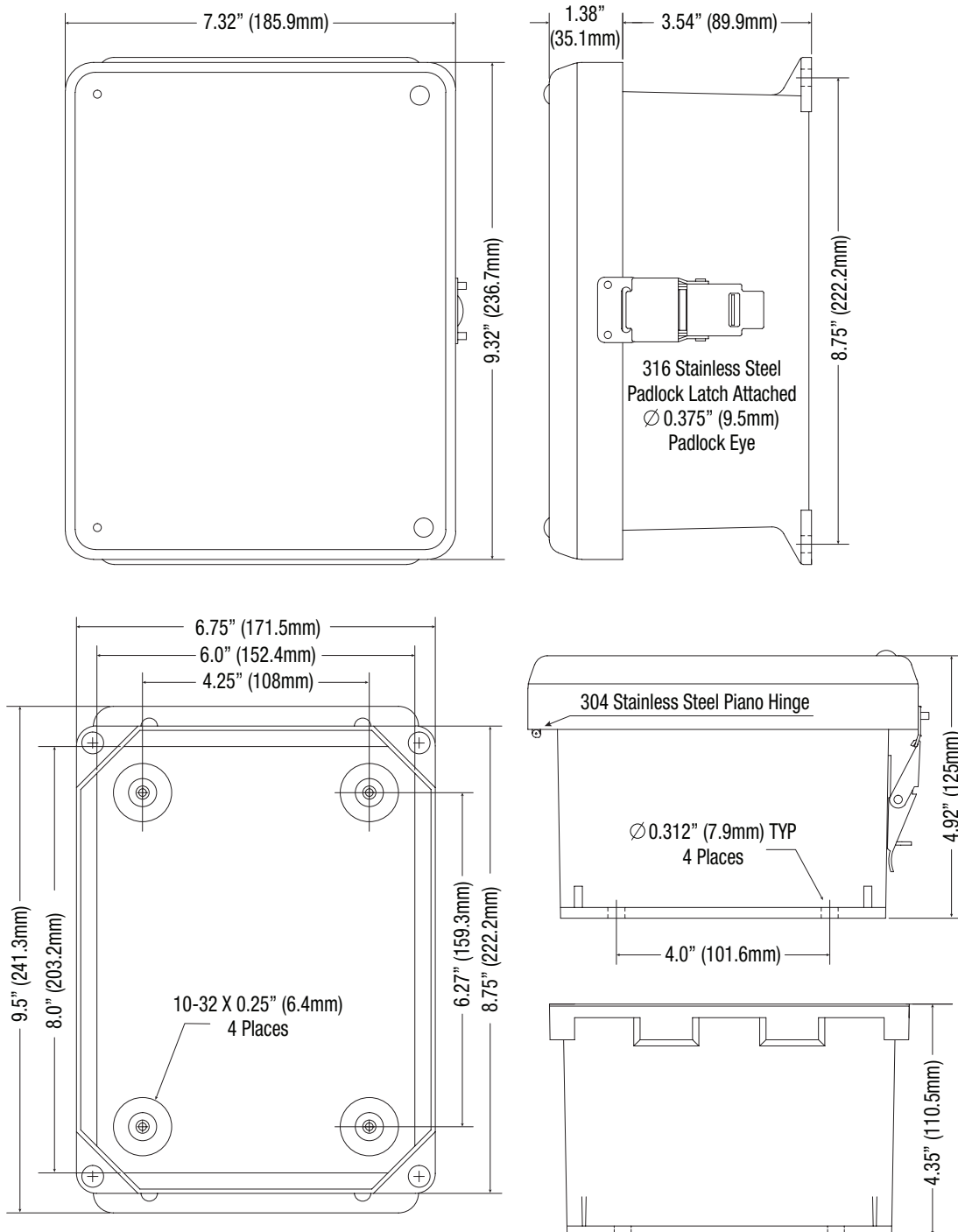

Lifetime Warranty

Altronix Corporation | 140 58th St | Brooklyn, NY 11220 USA

phone: +1 718.567.8181 | fax: +1 718.567.9056 | email: info@altronix.com | www.altronix.com