

## T1RM3CK1D (Pre-wired Kit)

### Rack Access and Power Integration Solution for Mercury



Altronix T1RM3CK1D is a 4-door access and power integration kit which includes Altronix power and sub-assemblies along with factory installed wire management and wire assemblies that are pre-configured with terminal blocks for Mercury\* hardware. This unit provides ample power and dual voltage outputs to support Mercury platform controllers and locking devices. The T1RM3CK1D accommodates one (1) Intelligent Dual Reader Controller and one (1) Dual Reader Interface Modules. Trove Plus simplifies field installations and provides reliable, robust critical power and control for the most demanding applications.



T1RM3CK1D - includes eFlow6NB, ACM4CB, VR6, PDS8CB, wire harnesses and management

*Mercury boards are not included*

#### \*Also compatible with these authentic Mercury partners:

AccessNsite, Avigilon, BadgePass, BluBox, Feenics, Genetec, Identocard, IMRON, Johnson Controls, Kastle, Keri Systems, LockState, Maxxess, Midpoint Security, NLSS, Open Options, Panasonic i-PRO MonitorCast, Quintron, RS2, S2 Security, Schneider Electric, Vanderbilt



### Key Features

- Accommodates the following Mercury controllers:
  - 1 - LP1502 / LP4502 and 1 - MR52
- Power status LED on front panel
- Simplified board layout and wire management
- Convenient knockout configuration:
  - Four (4) double knockouts - 3/4" Conduit and 1" Conduit
  - Two (2) double knockouts - 1/2" Conduit and 3/4" Conduit
- 6' IEC320 3-wire power cord
- 2U drawer on extendable rails
- Black powder coated steel enclosure
- Included Z Bracket facilitates ease of wiring
- Includes cam lock, tamper switch and mounting hardware
- CE European Conformity
- Lifetime Warranty\*

*\*Altronix Power Supply/Charger and Sub-Assemblies only*

### Accessories (order separately)



RE2

#### RE2 - Rack Mount Battery Enclosure

accommodates up to four (4) 12VDC/7AH batteries

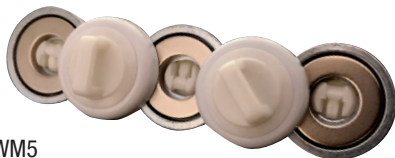

WM5

#### WM5, WM25, WM100 - Magnetic Cable Tie Mounts

Altronix WM5, WM25, and WM100 are packs of 5, 25 or 100 magnetic cable tie mounts respectively. They accommodate standard zip ties or velcro straps. These are ideal for wire management in our Trove series.

**Specifications**

**Power Supply/Charger (eFlow6NB):**

<b>Input</b>	
Voltage	120VAC, 60Hz. 3.5A
Input Fuse	5A/250V
<b>Output</b>	
Voltage	24VDC
Current	6A continuous
Auxiliary	1A (unswitched)
Other	Overvoltage protection. Filtered and regulated

**Battery Charging**

Type	Sealed lead acid or gel type
Failover	Upon AC loss, instantaneous
Batteries are sold separately	

**Supervision**

AC Failure	Form "C" contacts
Battery	Form "C" contacts

**Low DC Power Shutdown**

Shuts down DC output terminals if battery voltage drops below 70-75% for 24V units (depending on the power supply)  
 Prevents deep battery discharge

**Indicators (LED)**

Input	120VAC is present
DC Output	Powered
Battery	Discharged or not connected

**Dual Input Power Distribution Module (PDS8CB):**

<b>Input</b>	
Voltage	24VDC from eFlow6NB and 12VDC from VR6
Input PTCs	9A

**Outputs**

Voltage	12VDC and/or 24VDC
Any of the eight (8) power outputs are selectable to follow power Input 1 or Input 2	
Individual outputs may be set to OFF position for servicing	
Output PTCs	2.5A

**Indicators (LED)**

DC Output	Eight (8) individual output LEDs
Green:	12VDC
Red:	24VDC

**Voltage Regulator (VR6):**

<b>Input</b>	
Voltage	24VDC from eFlow6NB
<b>Output</b>	
Voltage	12VDC
Current	6A continuous
Other	Surge suppression

**Indicators (LED)**

Input	24VDC is present
Output	Powered

**Access Power Controller (ACM4CB):**

<b>Input</b>	
Voltage	24VDC from eFlow6NB
Input Fuse	10A/32V

**Outputs**

Voltage	24VDC
Four (4) independently controlled PTC outputs:	
a) Fail-Safe and/or Fail-Secure power outputs	
Form "C" Relays rated 28VAC or VDC @ 2.5A	
b) Auxiliary power outputs (unswitched)	
c) Any combination of the above	

Output PTCs	2.5A
-------------	------

**Indicators (LED)**

Red LEDs	Outputs are triggered (relays energized)
Green LED	FACP disconnect is triggered

**T1RM3CK1D Kit:**

**Agency Listings**

CE	European Conformity
----	---------------------

**Physical and Environmental:**

**Dimensions (H x W x D):**

Modular 2U standard EIA 19" rack mount chassis  
 Enclosure: 3.25" x 19.0" x 26.5" (82.6mm x 482.6mm x 673.1mm)  
 Shipping: 31" x 23" x 8.25" (787.4mm x 584.2mm x 209.6mm)

**Weights (approx.):**

Product:	20 lb. (9.07 kg)
Shipping:	25 lb. (11.34 kg)

**Temperature**

Operating:	0°C to 49°C (32°F to 120°F)
Storage:	- 20°C to 70°C (- 4°F to 158°F)

Relative Humidity 85% +/- 5%

BTU/Hr.: 87 BTU/Hr.

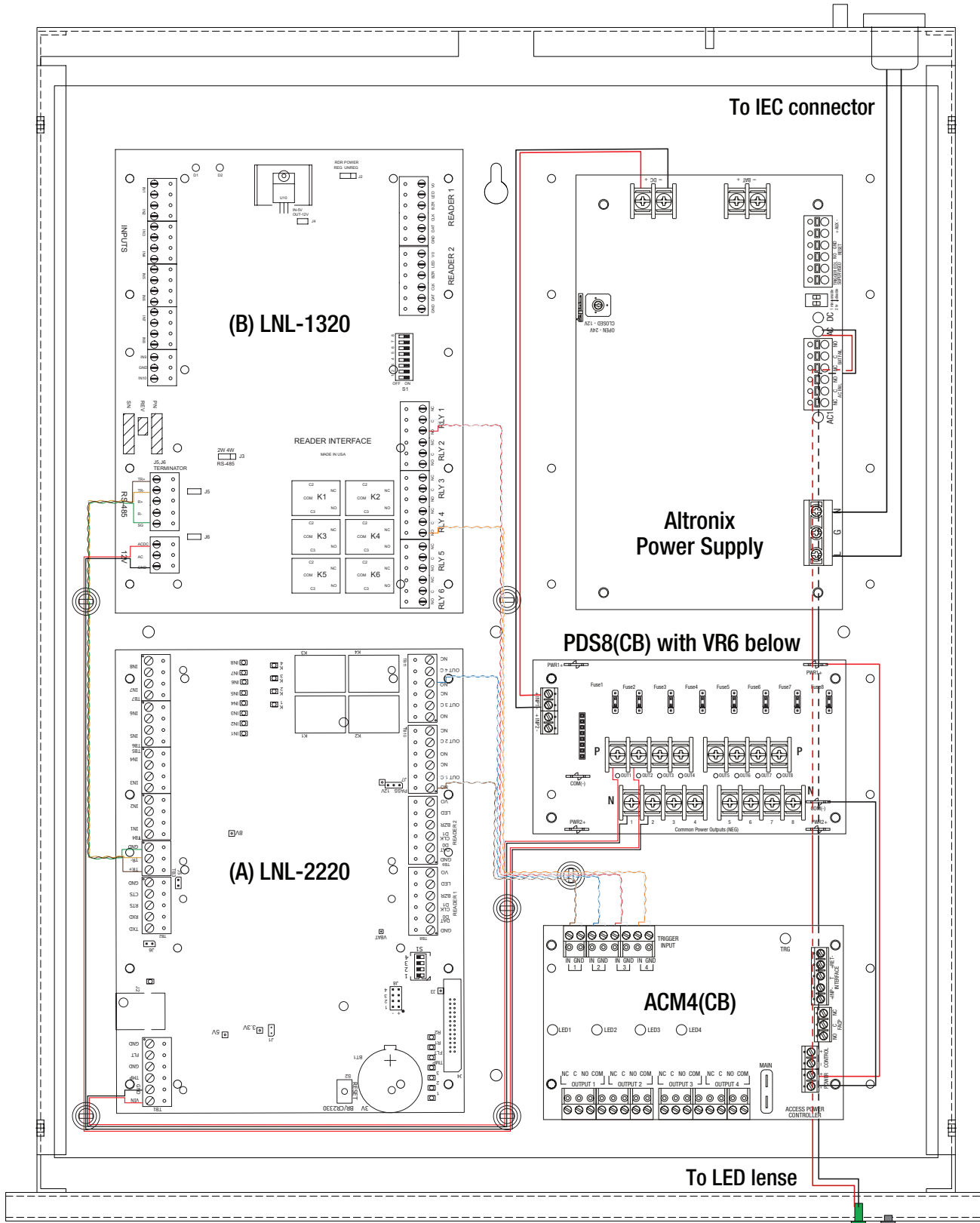

**Dimensions and Drawing**

Dimensions (H x W x D approximate)  
 3.25" x 19.0" x 26.5" (82.6mm x 482.6mm x 673.1mm)

