

## eFlow104NK1

### Dual Output Power Supply/Charger Kit



Ordering# EFLOW104NK1

Kit Contents: eFlow104N with VR6 UL Listed sub-assembly

Altronix eFlow104NK1 sub-assembly kit converts a 120VAC, 60Hz input into one (1) 5VDC or 12VDC selectable output at up to 6A supply current and one (1) 24VDC output. It also offers a suite of features that includes fire alarm disconnect, overvoltage protection, and low power disconnect which prevents deep discharge of stand-by batteries.



eFlow104NK1

### Key Features

- Reduces the cost of adding an additional power supply to achieve 24VDC and 12VDC or 5VDC simultaneously
- Additional aux. Class 2 power-limited output rated @ 1A
- Overvoltage protection
- Fire alarm disconnect
- Supervision
  - AC Fail
  - Battery Fail and Battery Presence
  - Low power shutdown
- Built-in charger for sealed lead acid or gel type batteries
- Instantaneous transfer to stand-by batteries
- Short circuit and overload protection
- AC input and DC output indicators
- Kit contents are UL Listed sub-assemblies
- CE European Conformity
- Lifetime Warranty

### Accessories (order separately)



LINQ2

#### LINQ2 - Network Supervision

Altronix LINQ2 Network Communication Module provides remote supervision, control and monitoring over LAN/WAN

- Remotely reports accurate power diagnostics
- Controls power and resets devices
- Reports system diagnostics via Email

#### Lifetime Warranty



## eFlow104NK1

Dual Output Power Supply/Charger Kit



### Specifications

#### Input

Voltage 120VAC, 60Hz, 4.5A max.  
Input Fuse 6.3A/250V

#### Outputs

Voltage Selectable 5VDC or 12VDC output and 24VDC output

Current 5VDC @ 6A continuous and 24VDC @ 8A continuous  
or  
12VDC @ 6A continuous and 24VDC @ 6A continuous

Auxiliary Class 2 power-limited @ 1A (unswitched)  
Other Overvoltage protection  
Filtered and regulated

#### Battery Charging

Capacity 7AH/12VDC (2 within enclosure)  
40AH/65AH (requires separate enclosure)

Type Sealed lead acid or gel type

Fuse Rating 15A/32V

Failover Upon AC loss, instantaneous  
Batteries are sold separately

#### Fire Alarm Disconnect

Supervised Latching or non-latching  
EOL 10K Resistor

#### Indicators (LED)

Input 120VAC is present  
DC Output Powered  
Battery Discharged or not connected

#### Supervision

AC Failure Form "C" contacts  
Battery Form "C" contacts

#### Low DC Power Shutdown

Shuts down DC output terminals if battery voltage drops below 71-73% for 12V units and 70-75% for 24V units (depending on the power supply)  
Prevents deep battery discharge

#### Agency Listings

##### eFlow104N

Access Control UL294, ULC-S319  
Burglar Alarm UL603, ULC-S318-96  
Fire Alarm UL1481  
CE European Conformity

##### VR6

Access Control UL294, ULC-S319  
CE European Conformity

#### Physical and Environmental

##### Dimensions (H x W x D)

Enclosure:  
13.5" x 13" x 3.25" (342.9mm x 330.2mm x 82.6mm)

Shipping:  
15" x 13.875" x 4.75" (381mm x 352.4mm x 120.6mm)

Enclosure accommodates up to two (2) 12VDC/7AH batteries

##### Weight (approx.)

Product: 6.9 lb. (3.13 kg)  
Shipping: 7.8 lb. (3.54 kg)

##### Temperature

Operating: 0°C to 49°C (32°F to 120°F)  
Storage: -20°C to 70°C (-4°F to 158°F)

Relative Humidity 85% +/- 5%

BTU/Hr. (approx.) 123 BTU/Hr.

#### Lifetime Warranty

**Dimensions and Drawing**

Dimensions (H x W x D approximate)

13.5" x 13" x 3.25" (342.9mm x 330.2mm x 82.55mm)

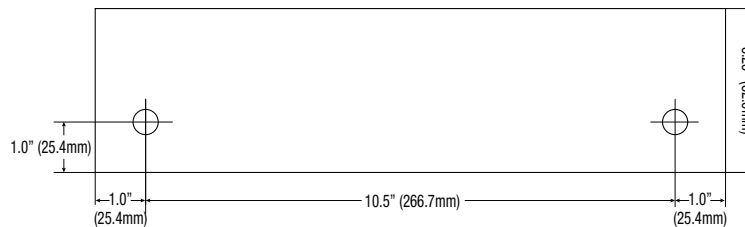
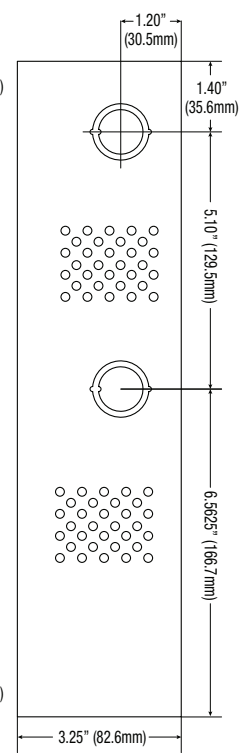
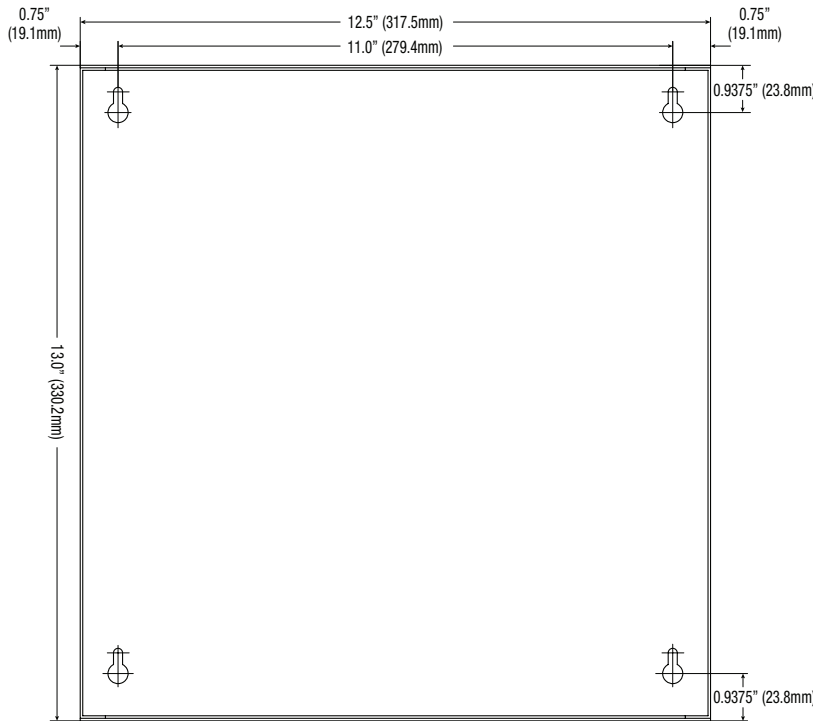
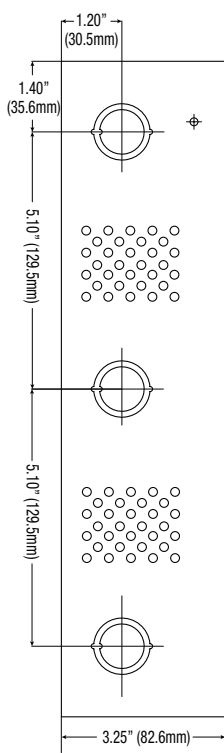
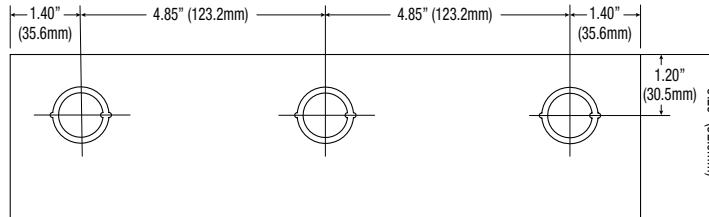

**Lifetime Warranty**

Altronix Corporation | 140 58th St | Brooklyn, NY 11220 USA

phone: +1 718.567.8181 | fax: +1 718.567.9056 | email: info@altronix.com | www.altronix.com